



Uniting the Heart & Science of Research

8th Annual Research Symposium

Program

**March 30, 2022
South Jordan Campus**

ROSEMAN UNIVERSITY
OF HEALTH SCIENCES

TRANSFORMING EDUCATION | REIMAGINING HEALTHCARE | EMBRACING DISCOVERY | COMMITTED TO COMMUNITY

**Access the 2022 Research Symposium Abstract Book at
research.roseman.edu/symposium**

or scan here



Agenda

2:00 – 3:00 PM

Check-In – All Poster Presenters

Front Lobby – Pharmacy Building

3:00 – 4:00 PM

**Welcoming Remarks by the Chancellor &
Podium Presentations**

P1 Classroom

4:00 – 5:00 PM

Poster Session – Meet the Researchers

Hallways outside D3 Classroom, Library, and
Student Commons.

5:00 – 5:15 PM

Break (Meal Served)

Food available for the first 130.
P1-1 Breakroom

5:15 – 6:15 PM

Keynote - Virtual

P1 Classroom

Dr. Annette Fleckenstein, M.S., Ph.D.

*Psychostimulant-induced Alterations in
Monoaminergic Transporters: Implications for
Neurotoxicity and Neuroprotection*

6:15 – 6:30 PM

Awards, Raffle & Closing Remarks

P1 Classroom

Keynote Speaker

Dr. Annette Fleckenstein, M.S., Ph.D.

Professor and Associate Dean for Basic Science Integration and for Faculty Development, School of Dentistry; Professor, Interdepartmental Program in Neuroscience
University of Utah

“Psychostimulant-induced Alterations in Monoaminergic Transporters: Implications for Neurotoxicity and Neuroprotection”

Annette Fleckenstein earned her BS and MS in Biomedical and Biological Sciences, respectively, from Western Michigan University. She then earned her PhD from the Department of Pharmacology and Toxicology at Michigan State University. After an Intramural Training Award postdoctoral fellowship at the National Institute on Drug Abuse (NIDA), she transitioned to the University of Utah as a postdoctoral fellow in the Department of Pharmacology and Toxicology. She eventually became a tenured Professor in that Department. In 2014, Dr. Fleckenstein transitioned to the University of Utah School of Dentistry (SOD). She is currently a tenured Professor, the Section Head for Oral Biology/Medicine/Pathology, and the Assistant Dean for Basic Science Integration at the University of Utah SOD. She is also a Professor in the Interdepartmental Program in Neuroscience at the University of Utah. Dr. Fleckenstein’s research has focused on psychostimulant-induced modifications of monoamine transport, and the implications of these alterations for neurotoxicity and neuroprotection. She has been a NIDA-funded researcher for over 20 years, has served on multiple National Institutes of Health review panels, and has authored numerous publications in peer-reviewed journals. Additionally, she is a co-author of the textbook, “Drugs and Society.” Dr. Fleckenstein was awarded a Kenneth E. Moore Distinguished Alumna Award from the Department of Pharmacology and Toxicology at Michigan State University, and a Distinguished Alumna award from the College of Arts and Sciences (Biological Sciences) at Western Michigan University. She is a Fellow of the American College of Neuropsychopharmacology.

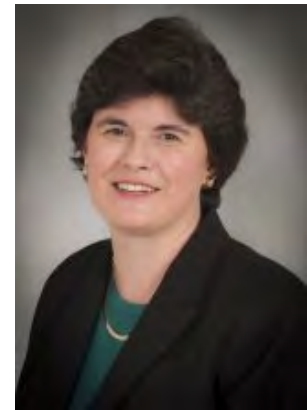

Podium Speakers

Time	Presentation
3:15 – 3:25 PM	<p><i>“Appearance of Reactive Hypoglycemia in otherwise Healthy Patients with Treatment-Resistant Migraine”</i></p> <p>Presented by Wyatt Magoffin Noorda College of Osteopathic Medicine</p>
3:30 – 3:40 PM	<p><i>“Monitoring Water Fluoride in America’s Community Water Systems”</i></p> <p>Presented by Jody Chiang Roseman University, College of Dental Medicine</p>
3:45 – 3:55 PM	<p><i>“Identification of Inhibitors of GSK-3 Beta from Natural Products”</i></p> <p>Presented by Vincent Anella Roseman University, College of Pharmacy</p>

Poster Session – Meet the Researchers

Basic Sciences	Poster Number	Title	Presenter
	1	Number of Active Social Media Users as a Predictor of HIPPA Infringements	Alexander Sheppert <i>Noorda College of Osteopathic Medicine</i>
	2	Novel Methodology for the Investigation of Dmrt3a Interneurons in Larval Zebrafish	Alfred Amendolara <i>Noorda College of Osteopathic Medicine</i>
	3	TrkB Activity Alters Voluntary Alcohol Consumption in Non-dependent Mice	Alfred Amendolara <i>Noorda College of Osteopathic Medicine</i>
	4	Effects of alcohol on the inflammatory response during <i>Toxoplasma gondii</i> infection	Amani Sastry <i>Noorda College of Osteopathic Medicine</i>
	5	CD5 Knockout Mice Exhibit Reduced Sensitivity to the Sedative Effects of Alcohol and Reduced Alcohol Seeking Behavior	Andrew Payne <i>Noorda College of Osteopathic Medicine</i>
	6	Peripheral Mechanoreceptor Activation Modulates Mesolimbic GABA and Dopamine Neurons and Ameliorates Withdrawal Symptoms in Ethanol Dependent Rats	Arazoo Shwany <i>Noorda College of Osteopathic Medicine</i>
	7	Voluntary Aerobic Exercise Protects Against Chronic Ethanol-Induced Changes to Kappa-Opioid Receptors	Armaghan Mardashti <i>Noorda College of Osteopathic Medicine</i>
	8	Sulforaphane Pre-treatment Improves Alveolar Macrophage Killing of Intracellular Burkholderia thailandensis E264 After Alcohol Exposure in vitro.	Caleb Harrop <i>Noorda College of Osteopathic Medicine</i>
	9	Evaluation of the Neurogenic and Dentinogenic Effect of Valproic Acid on Undifferentiated Mesenchymal Cells of Human Dental Pulp	Edward Yeates <i>Roseman University, College of Dental Medicine</i>
	10	Evaluation of Salivary Biomarkers for the Early Diagnosis of Periodontitis and Its Association with Hypertension	Elizabeth Uoo <i>Roseman University, College of Graduate Studies</i>
	11	A Quantitative Analysis of the Efficacy of Various Essential Oils Against the SARS Cov-2 Virus	Elizabeth Wagstaff <i>Brigham Young University, College of Life Sciences</i>
12	The Role of CD5 in Periodontal Disease: Insights into Chronic Inflammation	Ellie Bybee <i>Brigham Young University, College of Life Sciences</i>	

Basic Sciences

Poster Number	Title	Presenter
13	Manual Manipulation Analogue Ameliorates Morphine-Induced VTA GABA Neuron Desensitization and Behavioral Measures of Withdrawal	Gavin Jones <i>Noorda College of Osteopathic Medicine</i>
14	Genetic Knockdown of nmad-1 Demethylase in <i>C. Elegans</i> to Affect Longevity	Harlan Stevens <i>Brigham Young University, College of Life Sciences</i>
15	Investigation of Changes In Assembly and Function of the Peroxisomal Import Machinery in Human PEX10 Patient Fibroblasts	Jake Graff <i>Noorda College of Osteopathic Medicine</i>
16	Predicting Markers of Severe COVID-19 Through Transcriptomics Analysis	Jeffrey Clancy <i>Brigham Young University, College of Life Sciences</i>
17	Meta-Analysis of Transcriptomic Datasets for the Investigation of Differential Expression in Hantavirus-Infected Human Tissue	John Krapohl <i>Brigham Young University, College of Life Sciences</i>
18	Vitamin C Reduces IGF-1 and VEGF Signaling in Retinal Endothelial Cells	Jonathon Reynolds <i>Noorda College of Osteopathic Medicine</i>
19	Glutamine as an Acetyl-Lysine Mimic in Nucleosome Positioning Studies	Michael Mann <i>Brigham Young University, College of Life Sciences</i>
20	Periodontitis and Increased Cognitive Decline in Alzheimer's Disease	Nomikos Klonaris <i>Roseman University, College of Graduate Studies</i>
21	Blocking CTLA-4 for T Cell Activation	Rachel Morris <i>Brigham Young University, College of Life Sciences</i>
22	Interactions of Potential Addiction Pharmacotherapies and Substances of Abuse with the KCC2 Channel	Ruth Hunter <i>Noorda College of Osteopathic Medicine</i>
23	RNA Broccoli Aptamer to Track Transcription Rates In Vitro	Sarah Hodson <i>Brigham Young University, College of Life Sciences</i>
24	Meta-analysis of Two RNAseq Datasets to Determine Diagnostic Biomarkers and Drug target Candidates for Periodontitis	Carlos Moreno <i>Brigham Young University, College of Life Sciences</i>
25	Identification of Inhibitors of GSK-3 Beta from Natural Products	Edward Yeates <i>Roseman University, College of Pharmacy</i>
26	Activating VTA GABA Neurons Through Chemogenetic Stimulation of Connexin-36-targeted DREADDS	Hyrum Wright <i>Noorda College of Osteopathic Medicine</i>

	Poster Number	Title	Presenter
Clinical	27	Appropriate Use of Bone Protective Agents in Hormone-Sensitive Prostate Cancer	Danielle Gundrum <i>Roseman University, College of Pharmacy</i>
	28	Comparing the Efficacy of Sodium Fluoride and Silver Diamine Fluoride in Arresting Caries through Statistical Analysis.	Elana Ferris <i>Roseman University, College of Graduate Studies</i>
	29	Nutrition Evaluations in Patients with Zellweger Spectrum Disorder	Kaitlyn Janos <i>Noorda College of Osteopathic Medicine</i>
	30	Evaluation of Rituximab Infusion Rates at an Outpatient Infusion Clinic	Kimberly Wilson <i>Roseman University, College of Pharmacy</i>
	31	Effectiveness of the Matrix Model in Treating Substance Use Disorders as a Function of the Substances Abused	Odette Homsí <i>Noorda College of Osteopathic Medicine</i>
	32	Evaluation of Hepatitis B Screening for Patients Receiving Systemic Anticancer Therapy	Paul To <i>Roseman University, College of Pharmacy</i>
	33	Successfully Reducing Severe Asthma Exacerbations and Improving Asthma Control in a Pragmatic Study of African American/Black (AA/B) and Hispanic/Latinx (H/L) Adults with Moderate-Severe Asthma (PREPARE)	Alex Colon <i>Roseman University, College of Pharmacy</i>
	34	Appearance of Reactive Hypoglycemia in Otherwise Healthy Patients with Treatment-Resistant Migraine	Wyatt Magoffin <i>Noorda College of Osteopathic Medicine</i>
Other	35	Potential Cost Savings with Implementation of Systemwide Rasburicase Protocol	Parker Gundersen <i>Roseman University, College of Pharmacy, Intermountain Healthcare</i>
	36	Hospitalized Patients Use of Inhalers: Assessment of Wasted Doses	Samaya Cristina <i>Roseman University, College of Pharmacy</i>
	37	Utilization Of Medi-Cal Dental Benefits	Beatrice Bautista <i>Roseman University, College of Dental Medicine</i>

Public Health	Poster Number	Title	Presenter
	38	Media marketing of e-cigarettes: Calling Dental Education in Action	Ben Raymond <i>Roseman University, College of Dental Medicine</i>
	39	Current Trends in the SARS-CoV-2 Pandemic During the Emergence of the Omicron Variant	Benjamin Menell <i>Roseman University, College of Graduate Studies</i>
	40	Identifying Bias in Healthcare and Creating Intervention Strategies at Colleges of Medicine and other Healthcare Professions	Cameron Chalmers <i>Noorda College of Osteopathic Medicine</i>
	41	Succinic Semialdehyde Dehydrogenase Deficiency (SSADHD): Qualitative Needs Assessment for Patients With a Rare Neurologic Disorder	Cassandra Bovee <i>Noorda College of Osteopathic Medicine</i>
	42	Student Perceptions of COVID-19s Effect on Dental Education	David Stewart <i>Roseman University, College of Dental Medicine</i>
	43	Using a Reconciliatory Model to Change Attitudes Towards COVID-19	Gabriella Huhbble <i>Brigham Young University, College of Life Sciences</i>
	44	Uses of Orthodontia, Braces or Retainers Across Demographic Groups	Golnoush Zakeri <i>Roseman University, College of Dental Medicine</i>
	45	Efficacy of Vaccine and Naturally-Acquired Antibodies to SARS-CoV-2	Jaden Mindy, Bivash Arnold <i>Noorda College of Osteopathic Medicine</i>
	46	Monitoring Water Fluoride in America's Community Water Systems	Jody Chiang <i>Roseman University, College of Dental Medicine</i>
	47	Impact Of COVID19 on Stress, Self Esteem and Lifestyle Behavior Among Dental Students – A Cross-Sectional Study	Landon Ledingham <i>Roseman University, College of Dental Medicine</i>
	48	Roseman University of Health Science College of Dental Medicine Electronic Cigarette Awareness	Ryan Kinney <i>Roseman University, College of Graduate Studies</i>
	49	Social Impact of COVID-19 on University Healthcare Students Nationally and Internationally	Sukhkarn Gahunia <i>Roseman University, College of Graduate Studies</i>
	50	Reduced Access to Dental Care During COVID-19	Val Joseph Cheever <i>Roseman University, College of Dental Medicine</i>
51	Access To Dental Care During the Pandemic: A National Examination	Val Joseph Cheever <i>Roseman University, College of Dental Medicine</i>	

Scholarship of Teaching and Learning	Poster Number	Title	Presenter
	52	A Standardized Approach to Blood Pressure Training in First-Year Medical Students	Andrew Romney <i>Noorda College of Osteopathic Medicine</i>
	53	Popular Culture Devolves Students' Understanding of Evolution	Chandler Messer <i>Brigham Young University, College of Life Sciences</i>
	54	Early Patient Care and Biomedical Science Integration Increases Student Competence and Confidence	Edgar Tilley <i>Roseman University, College of Dental Medicine</i>
	55	Interprofessional (IPE) Activities and Interactions - A Comparison of Didactic Curriculum and Rotation Experiences	Emily Christiansen <i>Roseman University, College of Pharmacy</i>
	56	Participation in Curriculum/Cultural Ambassador Group to Enhance Student Belongingness	Jacob Tuft <i>Roseman University, College of Dental Medicine</i>
	57	Verbalized Studying and Elaborative Interrogation in the Virtual Classroom	Jordon Ockey <i>Brigham Young University, College of Life Sciences</i>
	58	The Implementation of Telehealth Scenarios and COVID-19 Training to Prepare Nurses for the Future of Healthcare	Shamar Lejardi <i>Roseman University, College of Nursing</i>
	59	Developing a Learning Tool for Roseman Pharmacy Students- The Continual Evolution of Roseman Basics	Taylor Taylor <i>Roseman University, College of Pharmacy</i>

8TH ANNUAL ROSEMAN UNIVERSITY RESEARCH SYMPOSIUM POSTER MAP

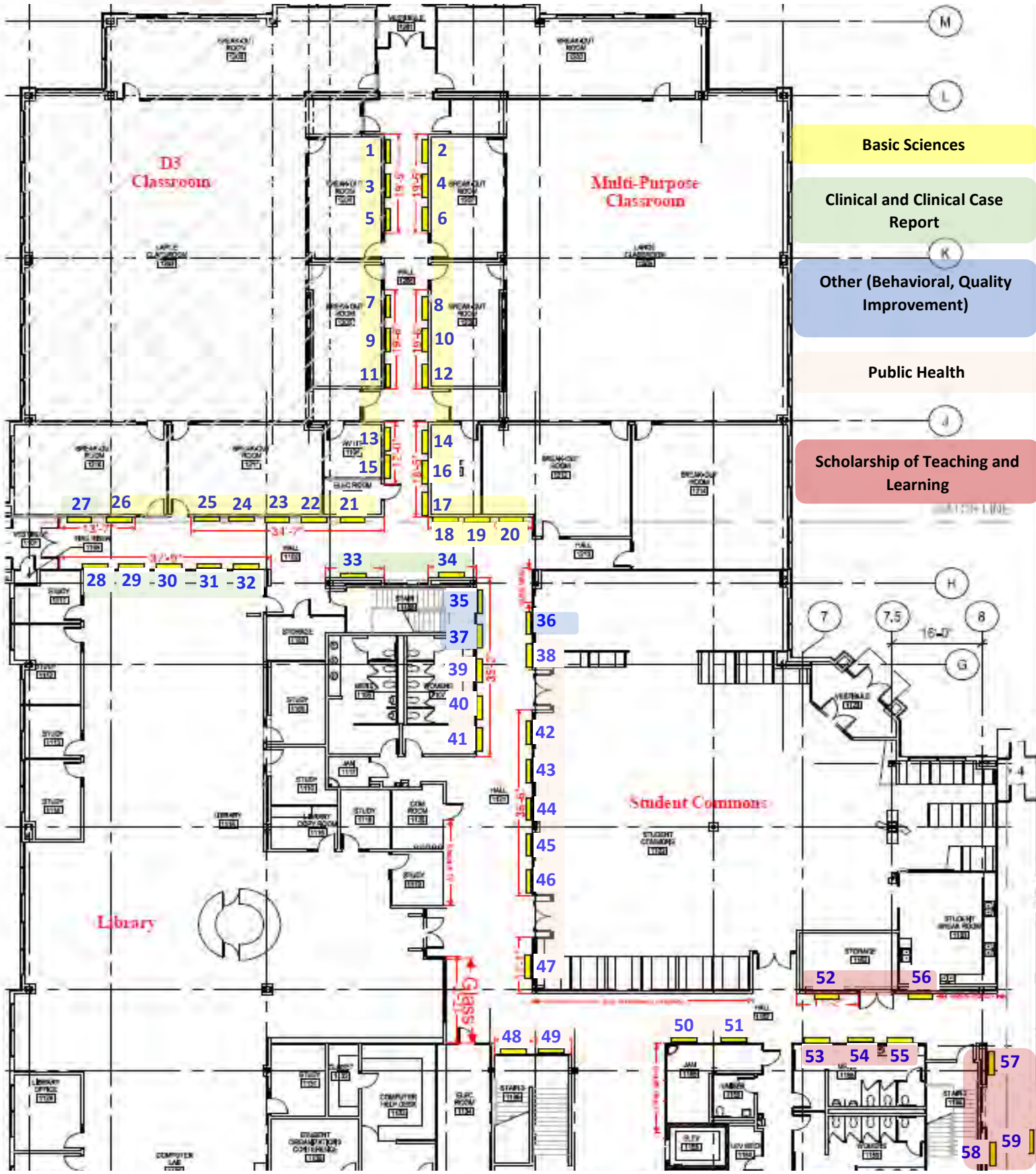

- Basic Sciences
- Clinical and Clinical Case Report
- Other (Behavioral, Quality Improvement)
- Public Health
- Scholarship of Teaching and Learning



ROSEMAN UNIVERSITY OF HEALTH SCIENCES

TRANSFORMING EDUCATION | REIMAGINING HEALTHCARE | EMBRACING DISCOVERY | COMMITTED TO COMMUNITY